



Welcome to the Allnutt & Baker Almshouse and Educational Trust at Goring Heath, Oxfordshire – Appointment of a Chaplain (House for Duty)

Goring Heath Almshouses are 23 tranquil acres set in an Area of Outstanding Beauty in South Oxfordshire. They comprise of St Bartholomew's Chapel, twelve almshouses, a resident's common room and three other residential properties which are rented on the open market.

The Charity was established in 1726, so we are approaching our 300th anniversary next year.

Whilst the Almshouses were completed in 1726, the first residents were admitted in 1727. The Chapel was not consecrated until 1742 when it was dedicated to St Bartholomew and an ordained Chaplain was licensed to serve it.



The Charity itself (Charity number 211836) is managed by a board of six voluntary Trustees, all of whom live locally. It employs a full time Warden who lives on site with his wife and a part time Clerk who works two mornings a week, Monday and Wednesday. The Trustees meet on a quarterly basis, generally on Friday morning. The Charity has a sound financial standing, and its last accounts are available on request.

We currently have twelve single residents and two couples. All are of limited means and have a connection to local area and range in age from 58 to 92. All residents are expected to be capable of independent living.

The Chaplains Role

We are looking for an enthusiastic person who will act as Chaplain to the residents of the Almshouses and perform divine services and other spiritual duties according to the Book of Common Prayer and the King James Bible on Sundays, Holy Days and other appropriate times.

We would expect the Chaplain to visit the Residents on a regular basis to get to know them for the purpose of their general welfare and promote their happiness and comfort. The role also includes welcoming and getting to know those who live in the local area and who worship in the Chapel.

The Chaplain will also provide cover for the Warden on his days off and holidays when they will be in sole charge and responsible for the residents.

The Chaplain will be paid an annual stipend of £6,000 and attend the Trustees' quarterly meetings to present their report.

Housing



The Chaplain will live in School House which adjoins the Western end of the Almshouses. This is a character three-bedroom property with spacious accommodation, a generous sized garden and gravel driveway for parking.

**School House,
Goring Heath Almshouses, RG8 7RS**
Approx. Gross Internal Area 1191 Sq Ft - 110.65 Sq M

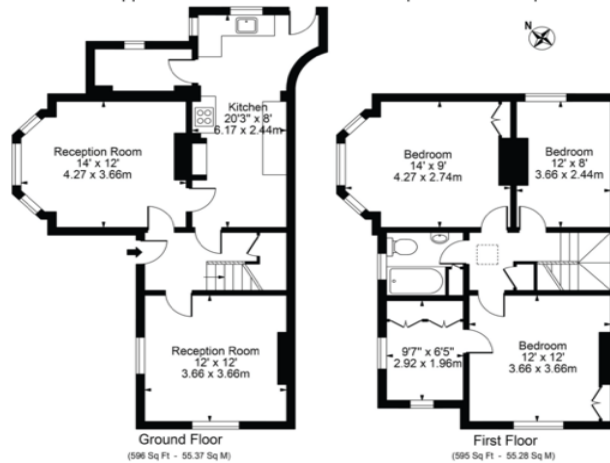

For Illustration Purposes Only - Not To Scale

This floor plan should be used as a general outline for guidance only and does not constitute in whole or in part an offer or contract.
Any intending purchaser or lessee should satisfy themselves by inspection, searches, enquiries and full survey as to the correctness of each statement.
Any areas, measurements or distances quoted are approximate and should not be used to value a property or be the basis of any sale or let.

The Charity will provide School House on a rent-free basis along with all utilities and services including Council Tax save for telephone and broadband costs.

Location

Goring Heath Almshouses are three miles from Pangbourne, four miles from Goring on Thames, seven miles from Reading and nine miles from Henley on Thames. There are train stations at all these locations with the fastest direct link to London being through Reading.

The post code is RG8 7RS and a car is essential for personal transport given our rural location.

Education

The area offers a good range of state primary and secondary schooling including Langtree Secondary school, Whitchurch on Thames primary school together with a good selection of independents including The Oratory and Pangbourne College.



For further information and an application form please contact the
Chairman of the Trustees. garryjforster@gmail.com



Please open these links to two short videos of the Almshouses and Chapel

<https://www.dropbox.com/scl/fi/f3iv3n937m2f4m2onsek4/VIDEO-2025-04-30-10-07-28.mp4?rlkey=80sja6rec3d22esggqvqycj04&dl=0>

<https://www.dropbox.com/scl/fi/n3ifearxf7vvu8biq5npe/VIDEO-2025-04-30-10-06-46.mp4?rlkey=8iknxhg9qweawtq91lg5nq8er&dl=0>